

ES/DS/WS 220 IP 话机快速操作指南

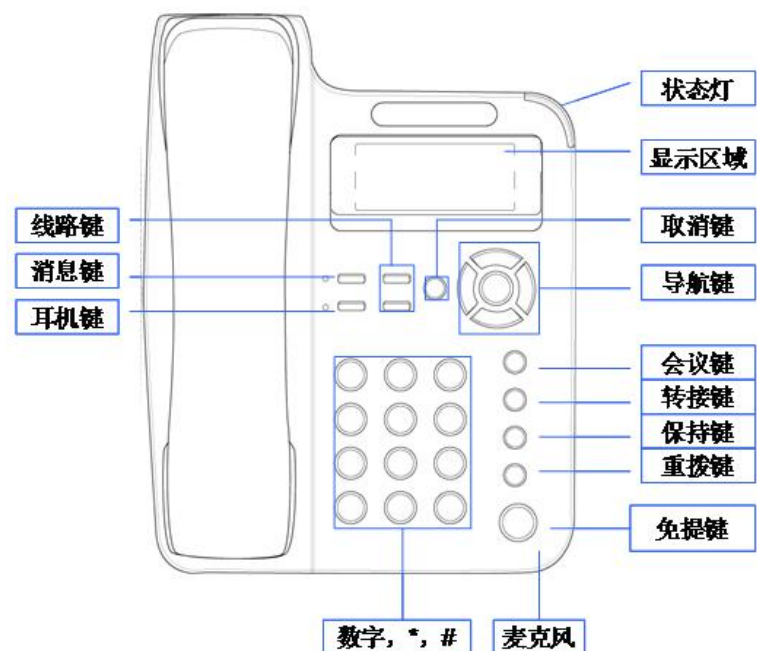

LEDs

表 1 状态灯

LED 灯状态	描述
红色闪烁	对应线路有来电正在呼入
红色常亮	对应线路摘机且正在进入正常通话状态
免提	对应功能正启用

安装支架, 话机接入

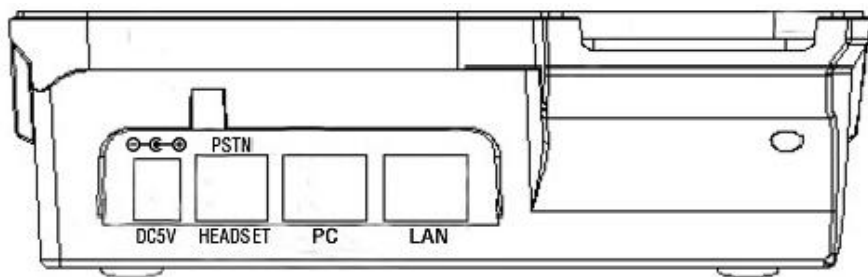

- PC 口 连到电脑 PC 上, 话机的 LAN 口 是连到 Internet (局域网、外网), PSTN 口接 PSTN 线路。

- 话机手柄接线:

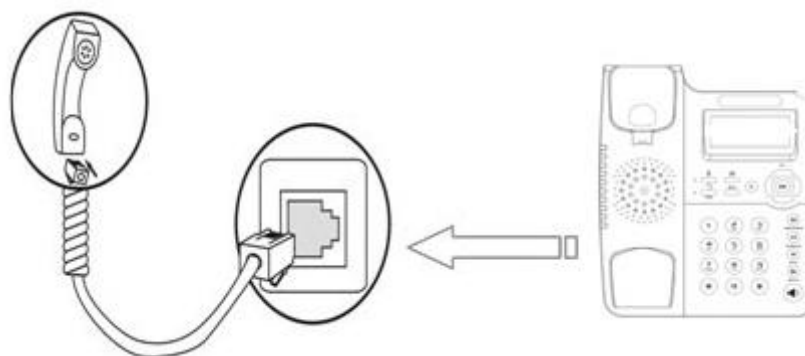

网络设置

- 步骤为: 按话机上的菜单键 **MENU** => **系统设置** => **高级设置** => 输入高级设置密码 (默认为空) 直接按 **OK** => **网络** => **LAN 网络接口** => 按 **OK**, 网络类型: 有以下选项:
 - 静态 IP --- 设置静态 ip 地址
 - PPPoE --- ADSL 自动拨号
 - DHCP --- 自动获取 ip 地址
 选择**静态 IP** 后按导航键-下, 看到 IP 地址设置, 可对 IP 及网关等相关网络信息进行设置, 其中“.”请用键“*”输入。
 选择**PPPoE** 输入账号和密码就可以注册获取 ip 地址。
 选择**DHCP** 不用设置 IP, 将从 DHCP 服务器获取 ip 地址。
- * **DS 2xx** 有 PSTN 功能, 直接插上 PSTN 口就能通话, 如不用 PSTN, 请参照上面的操作。
- * **WS 2xx** 周边环境如果有无线 AP, 在**系统设置**->**WIFI 设置**->**热点列表**, 选择一个**热点**, 在里面设置 SSID 密码。(没有密码不用设置)
 具体步骤: 按 **SSID** => **key** => 输入密码, 如果无线的加密类型 **Security type** 不同, 可按 **OK** 选择. 设置完之后按 **Submit** 提交

注册账号

- 按话机上的菜单键 **MENU** => **系统设置** => **高级设置** => 输入高级设置密码 (默认为空) 直接按 **OK** => **Sip** => **帐号 Sip 设置** => **帐号 1**, 之后分别配置以下参数:
 - 是否启用帐号** 中选择**开启**,
 - 帐号**: 输入 SIP 帐户名,
 - 密码**: 输入 SIP 账户密码,
 - 主 SIP 域名**: 输入 SIP 服务器 IP (“.” 请用键*输入, 注意 IP 话机与 SIP 服务器间网络必须可达), 之后选取**提交**, 再按下 **OK** 键, 即可完成 SIP 账户的添加。

发起呼叫

您可以摘机或按下**耳麦键**或**免提键**来进行一个呼叫。

- **直接呼叫**: 直接拨打号码, 然后按**#键**或按 **Send** 软键;
- **PSTN 呼叫**: 如要进行 PSTN 呼叫, 请先按下 PSTN 的**线路键**, 再进行拨打号码等呼叫操作 (断电情况下直接手柄摘机拨号);
- **重拨**: 按**重拨键**或 **Redial** 软键以拨打最近一个拨出的号码;
- **从呼叫记录进行呼叫**: 按**菜单键**, 选择“Call history”, 再选择“Missed calls”、“Received calls”或“Dialed numbers”列表来选择一个号码, 再按**呼叫软键**进行呼叫。

在话机待机状态下, 按下**导航键**也可快速进入呼叫记录:

- 导航键-左为“已接电话”;
- 导航键-右为“已拨电话”;
- 导航键-下为“未接电话”;
- 导航键-上为“调音量”;
- “OK” 键为确认键;
- “C” 键为取消键。

*更多的详细内容以及话机配置信息请参考本话机的用户手册。您也可以**通过访问话机的 Web 页面来进行更详细的参数配置**, 在浏览器中输入 IP 话机的地址, 输入话机的用户名、密码 (默认均为 root), 即可进入了 IP 话机的网页配置界面。

ES/DS/WS 220 IP Phone Quick Guide

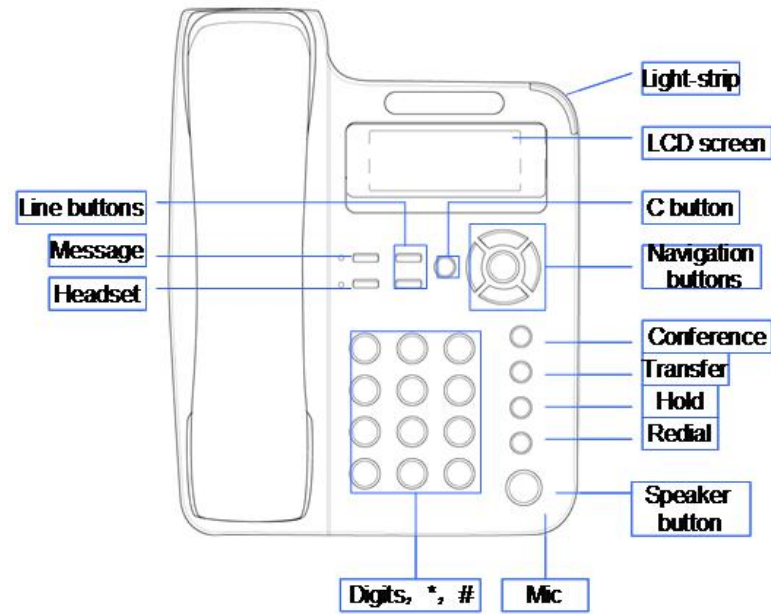

LEDs

- Table 1 Light-strip

LED Status	Description
Red, flashing	There is an incoming call.
Red, steady	Hook-off. enter a usual conversation
Speaker	The corresponding function is enabled.

Mounting bracket, telephone access

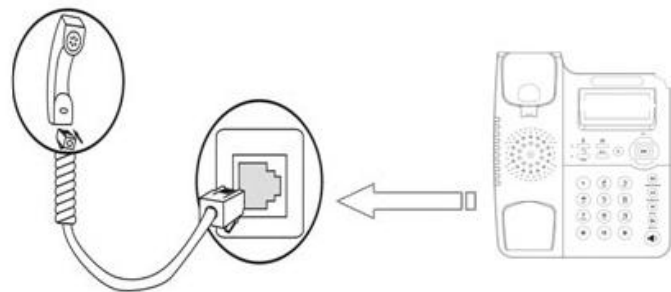
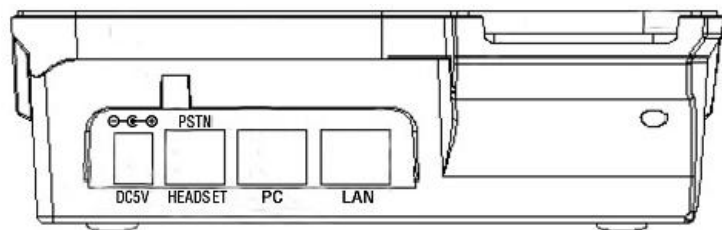

2-1

- PC port to PC, LAN port access outside the network, EXT Socket Extension units, SOR (PSTN) port access PSTN, Upper right to power, the right of access RJ11 headset, the lower right of access a handset.

Network Settings

- Steps: Press the menu button on the phone **MENU=> System setting=> Advanced setting=>Enter Advanced Password** (Empty by default)=>LAN setting=> pressing **OK => Network => click OK**
TYPE has the following options : **STATIC、PPPOE、DHCP**
Choose **STATIC** press Navigation key - to the next, see the IP address settings, the IP and gateway settings and other related network information, including "." Use the key "*" entry.
Select **PPPoE** username and password to register.
Select **DHCP** needn't to setting ip.
- * **DS 2xx** with PSTN functions, able to directly plug in the PSTN port calls, such as no PSTN, please refer to the above operation.
- * **WS 2xx** if there is wireless AP in surrounding environment, you can choose the **System setting -> WIFI setting-> hot list**, choose a hot in ,set the **SSID** password (no password is not set)
Specific steps: Press **SSID => key => password**, if the wireless encryption type is different, choose **Security type**, press **OK** to select. After setting, remember to press Submit.

Registered account

- On the phone, press **MENU** button => **System Setting => Advanced Setting=>type Advanced password** (it is idle by default) and press **OK** button=> **SIP=> Accounts SIP =>Account 1**, and then set the parameter as follow: **Enable Account:** Select Enable,
Username: Type your SIP account,
User Pwd: Type your SIP password,
SIP1: Type the IP address of your SIP server (you can type "." by "*" button, you must confirm the connection between the phone and SIP server)
And then select Submit changes. and press OK button to submit the changes.

2-2

Placing a Call

You can pick up the handset or press **Headset/Speaker** button to place a call.

- Dial directly:** Dial number directly, then press # button or Send soft-key (it will call from the first available line);
- PSTN call:** Press the Line button of PSTN, and then dial number (Hook off your handset and dial directly when it is power down);
- Redial:** Press **Redial** button/soft-key to dial the latest number;
- Dial from Call history:** Press **Menu** button, select "Call history" and select one of "Missed calls", "Received calls" and "Dialed numbers" lists to dial by pressing **Dial** soft-key.

You can open Call history in standby status of phone by pressing corresponding Navigation-buttons, for example , **Left** button : "Received Calls" list ; **Right** button : "Dialed Numbers" list ; **Down** button : "Missed Calls" list . **UP** button : "tone volume" ;"**OK**" button to confirm the key ; next to the "**C**" key for the Cancel button.

***This document introduces normal function operation of IP phones only. For details (operation and configuration), refer to User Manual. And set details on the web page of phone. In the browser, enter the IP phone's address, enter the phone's user name and password (the default are root), enter the IP phone's web configuration interface.**

2-3